

KSR231 Series

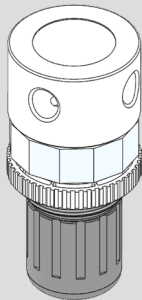

KSR231-02

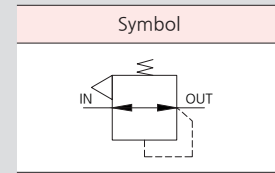

Features

- Used STS materials that are resistant to corrosion and wear

How to order

※ The symbols are displayed alphabetically.

KSR231 - 02 B T

① ② ③ ④ ⑤

① Model

KSR231	Corrosion-resistant STS Regulator
--------	-----------------------------------

② Thread type

Nil	Rc(PT) (Standard)
G	G
N	NPT

③ Port type

Item		KSR231	
		Body	Pressure gauge port size
01	Rc(PT)1/8	●	Rc(PT) 1/8
02	Rc(PT)1/4	●	

④ Bracket

Nil	None
B	Bracket+Fixed nut (Standard)

※ Bracket is packaged separately.

⑤ Pressure gauge

Nil	None
T	Circular gauge

Specifications

Fluid	Air
Proof pressure	1.5MPa
Max. operating pressure	1.0MPa
Regulating pressure range	0.07~0.85MPa
Port type	Rc(PT) 1/8, 1/4"
Gauge connection	Rc(PT) 1/8"
Ambient & fluid temperature	5~60℃
Structure	Relief type

※ Please inquire about the Non-relief type.

⚠ Handle with care

1. Check direction when connecting pipes. (Connect to "IN" side.)
2. Make sure there are no foreign substances in the pipe.

Structure

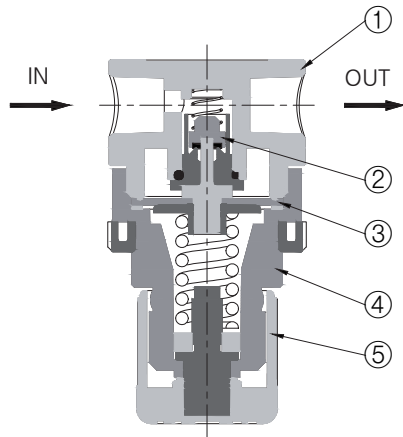

No.	Parts	Materials
1	Body	STS
2	Valve	NBR+STS
3	Diaphragm	NBR
4	Bonnet	POM
5	Handle	POM

Dimensions

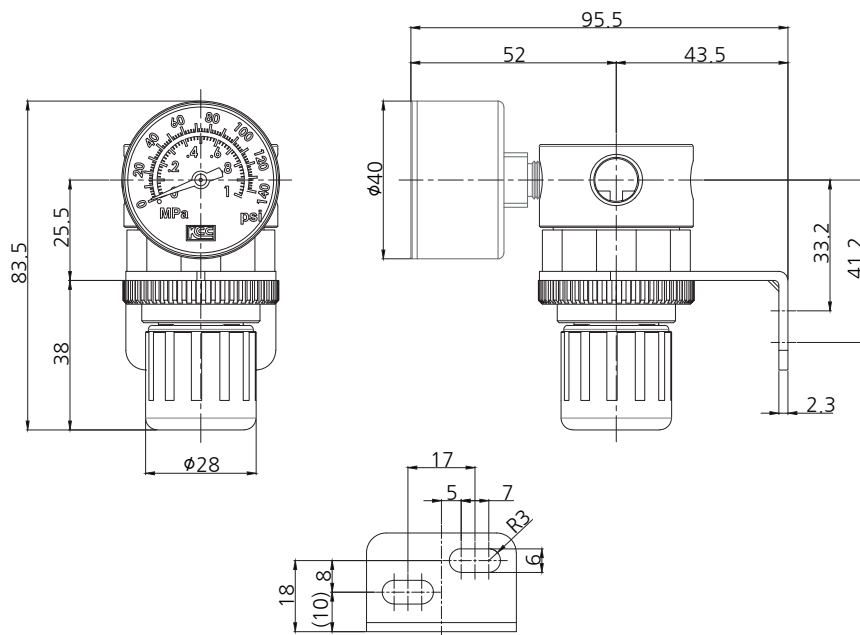

L-Bracket Hole dimensions